

## CORNER RECORD

COUNTY OF ~~INYO~~ MONO T. 1N R. 26E MDB E MERIDIAN CALIFORNIA  
 CORNER TYPE: GOV'T. CORNER ☒ MEANDER ☐ RANCHO ☐ CONTROL ☐ OTHER ☐  
 CORNER IDENTIFICATION - DATE OF VISIT OCT. 25 19 84

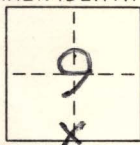

S  $\frac{1}{4}$   
 Sec. 9

CORNER - LEFT AS FOUND ☒ FOUND AND TAGGED ☐ REESTABLISHED OBLITERATED CORNER ☐ REBUILT ☐

PHYSICAL DESCRIPTION OF CORNER FOUND: EVIDENCE AND METHOD USED TO IDENTIFY OR REESTABLISH FND. IN GOOD  
COND.  $\frac{5}{8}$ " rebar w/  $\frac{3}{4}$ " RCE Tag 30029 attached,  $02' \pm$  above grnd,  $8' \pm$  E. of  
 $6\frac{1}{2}" \pm$  dia. Yellow colored iron pipe,  $55' \pm$  above grnd,  $20' \pm$  S. of travelway,  
 $210' \pm$  E. of NW corner of METAL BLDG,  $1300' \pm$  N. of U.S. Pumice Entry  
ROAD AND Hwy 395.

PHYSICAL DESCRIPTION OF MONUMENTS REBUILT OR PERPETUATED

Job - 203702

09400

PHOTOS: Roll 2

20 EXP'S

#11) Closeup looking W

#12) View looking W

#13) View looking S

CALIFORNIA COORDINATE SYSTEM ORDER: FIRST ☐ SECOND ☐ THIRD ☒  
 STATIONS USED: NGS (USC & GS) ☒ STATE ☐ COUNTY ☐ OTHER ☐ STATION LEE VINING STATION LEE VINING  
 ZONE 3 ELEVATION 6816  $\pm$  NORTHINGS (Y) 532,045.7  $\pm$  EASTINGS (X) 2,399,753.1  $\pm$

SKETCH: (Include reference tie or witness points, remarks and topo of area)

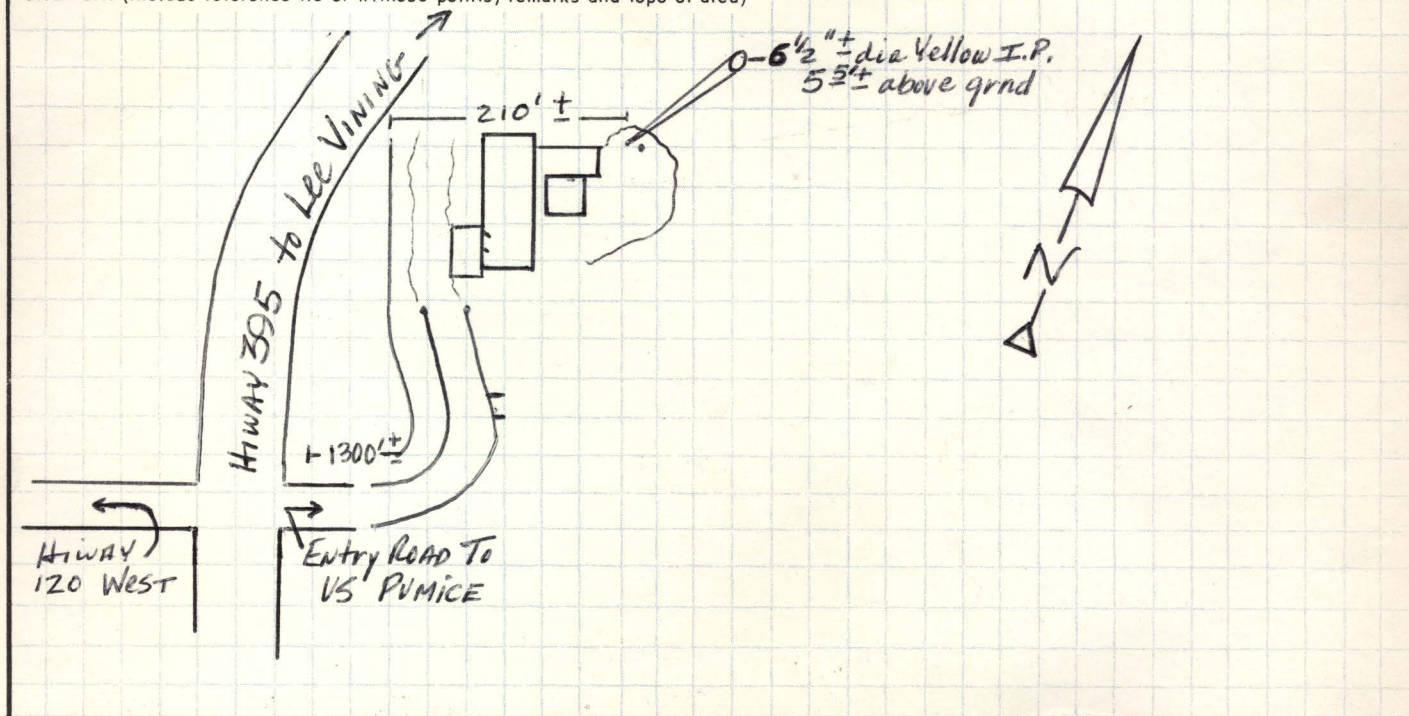

## SURVEYOR'S CERTIFICATE

THIS CORNER RECORD WAS PREPARED BY ME OR UNDER MY  
 DIRECTION IN CONFORMANCE WITH THE LAND SURVEYORS ACT  
 ON 25 Oct 19 84

SIGNED: MMW Altstead

L.S. or R.C.E. No.: CALTRANS P.C.

SEAL

## COUNTY SURVEYOR'S CERTIFICATE

THIS CORNER RECORD WAS RECEIVED 1-11-19-85  
 AND EXAMINED AND FILED 1-17-19-85

BY: Richard B. Bunker

TITLE: Deputy County Surveyor

DOCUMENT No. IN 26-9-5

STATEMENT ON BACK OF SHEET

YES ☐ NO ☒