

OWNER'S STATEMENT:

THE UNDERSIGNED HEREBY STATES THAT IT IS THE OWNER OF THE LAND DELINEATED AND EMBRACED WITHIN THE EXTERIOR BOUNDARY LINES ON THE HEREIN EMBODIED PARCEL MAP ENTITLED "PARCEL MAP 10337, CITY OF OAKLAND, COUNTY OF ALAMEDA, STATE OF CALIFORNIA"; THAT SAID OWNER ACQUIRED TITLE TO SAID LAND BY VIRTUE OF THE GRANT DEED RECORDED FEBRUARY 18, 2015, UNDER SERIES NO. 2015-047066 IN THE OFFICIAL RECORDS OF ALAMEDA COUNTY, STATE OF CALIFORNIA: THAT IT CONSENTS TO THE PREPARATION AND FILING OF THIS PARCEL MAP.

THE AREA DESIGNATED AS "E.V.A.E" IS A NON-EXCLUSIVE EASEMENT RESERVED FOR THE CITY OF OAKLAND FOR INGRESS AND EGRESS OF EMERGENCY VEHICLES OF ALL KINDS. THIS EASEMENT SHALL BE KEPT FREE OF PARKED VEHICLES AND OBSTRUCTIONS AT ALL TIME. THE CITY OF OAKLAND IS AN INTENDED THIRD PARTY BENEFICIARY OF THIS EASEMENT AGREEMENT WITH THE RIGHT TO ENFORCE THE RIGHTS AND OBLIGATIONS SET FORTH HEREIN, AT ITS SOLE DISCRETION. THIS EASEMENT AGREEMENT MAY NOT BE MODIFIED OR TERMINATED WITHOUT THE WRITTEN CONSENT OF THE CITY OF OAKLAND.

THE AREA DESIGNATED AS "P.A.E." IS AN IRREVOCABLE RESERVATION FOR A NON-EXCLUSIVE EASEMENT RESERVED FOR THE OWNER(S) OF LOT 2 FOR ACCESS PURPOSES. RIGHTS ARE LIMITED TO UNOBSTRUCTED INGRESS AND EGRESS OF VEHICLES AND PEDESTRIANS. THIS EASEMENT SHALL BE KEPT FREE OF PARKED VEHICLES AND OTHER OBSTRUCTIONS AT ALL TIMES. THE MAINTENANCE OF SAID PRIVATE ACCESS EASEMENT SHALL BE MUTUALLY SHARED BY THE OWNERS OF LOTS 1 AND 2. THIS IRREVOCABLE RESERVATION SHALL BECOME AN EASEMENT AT THE TIME OF THE FIRST TRANSFER OF LOT 1 OR LOT 2 INTO SEPARATE OWNERSHIP.

3294 LOUISE STREET, LLC, A California limited liability Company

Kathy Kuhner
KATHY KUHNER
MANAGING MEMBER

OWNER'S ACKNOWLEDGEMENT:

A NOTARY PUBLIC OR OTHER OFFICER COMPLETING THIS CERTIFICATE VERIFIES ONLY THE IDENTITY OF THE INDIVIDUAL WHO SIGNED THE DOCUMENT TO WHICH THIS CERTIFICATE IS ATTACHED, AND NOT THE TRUTHFULNESS, ACCURACY, OR VALIDITY OF THE DOCUMENT.

STATE OF CALIFORNIA)

COUNTY OF Alameda

ON July 28, 2015 BEFORE ME, Michael Reams, a Notary Public
A NOTARY PUBLIC IN AND FOR SAID COUNTY AND STATE, PERSONALLY APPEARED

KATHY KUHNER

WHO PROVED TO ME ON THE BASIS OF SATISFACTORY EVIDENCE TO BE THE PERSON WHOSE NAME IS SUBSCRIBED TO THE WITHIN INSTRUMENT AND ACKNOWLEDGED TO ME THAT SHE EXECUTED THE SAME IN HER AUTHORIZED CAPACITY, AND THAT BY HER SIGNATURE ON THE INSTRUMENT, THE PERSON, OR THE ENTITY UPON BEHALF OF WHICH THE PERSON ACTED, EXECUTED THE INSTRUMENT.

I CERTIFY UNDER PENALTY OF PERJURY UNDER THE LAWS OF THE STATE OF CALIFORNIA THAT THE FOREGOING PARAGRAPH IS TRUE AND CORRECT.

WITNESS MY HAND.

NOTARY PUBLIC

NAME: Michael Reams

MY COMMISSION EXPIRES: Dec. 13, 2017

MY COMMISSION NUMBER: 2051649

COUNTY OF PRINCIPAL PLACE OF BUSINESS: Alameda

CITY SURVEYOR'S STATEMENT:

I, GILBERT E. HAYES, CITY SURVEYOR, HAVING BEEN AUTHORIZED TO PERFORM THE FUNCTIONS OF THE CITY SURVEYOR OF THE CITY OF OAKLAND, COUNTY OF ALAMEDA, STATE OF CALIFORNIA, DO HEREBY CERTIFY THAT I HAVE EXAMINED THE HEREIN EMBODIED PARCEL MAP ENTITLED, "PARCEL MAP 10337, CITY OF OAKLAND, COUNTY OF ALAMEDA, STATE OF CALIFORNIA"; AND I AM SATISFIED THAT THE PARCEL MAP IS TECHNICALLY CORRECT.

IN WITNESS WHEREOF, I HAVE HEREUNTO SET MY HAND THIS 29th
DAY OF July 2015.

GILBERT E. HAYES, P.L.S. NO. 4700
CITY SURVEYOR
CITY OF OAKLAND, ALAMEDA COUNTY
STATE OF CALIFORNIA

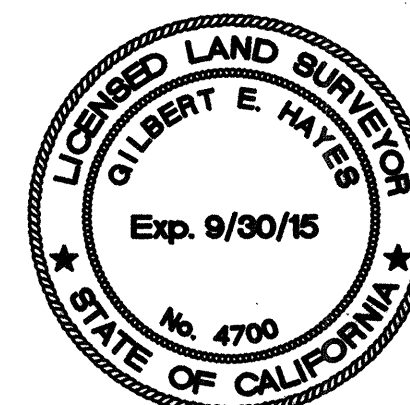

CITY ENGINEER'S STATEMENT:

I, MICHAEL J. NEARY, CITY ENGINEER, HAVING BEEN AUTHORIZED TO PERFORM THE FUNCTIONS OF THE CITY ENGINEER OF THE CITY OF OAKLAND, DO HEREBY CERTIFY THAT I HAVE EXAMINED THE HEREON EMBODIED PARCEL MAP ENTITLED "PARCEL MAP 10337, CITY OF OAKLAND, COUNTY OF ALAMEDA, STATE OF CALIFORNIA"; THAT THE SUBDIVISION AS SHOWN UPON SAID PARCEL MAP IS SUBSTANTIALLY THE SAME AS THAT APPEARING ON THE TENTATIVE PARCEL MAP AND ANY APPROVED ALTERATIONS THEREOF; THAT SAID PARCEL MAP COMPLIES WITH ALL PROVISIONS OF THE SUBDIVISION MAP ACT OF THE GOVERNMENT CODE AND THE LOCAL ORDINANCES APPLICABLE AT THE TIME OF THE TENTATIVE PARCEL MAP.

IN WITNESS WHEREOF, I HAVE HEREUNTO SET MY HAND THIS 29th
DAY OF July 2015.

MICHAEL J. NEARY, R.C.E. NO. 38547
CITY ENGINEER
CITY OF OAKLAND, ALAMEDA COUNTY
STATE OF CALIFORNIA

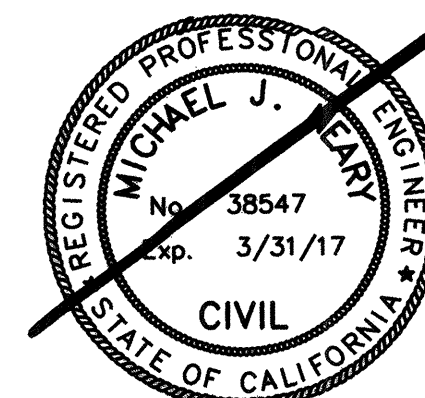

BY Abolghassem Amirzehni
ABOLGASSEM AMIRZEHNI
ACTING CITY ENGINEER
PE C44617 - EXPIRES 3/31/16

SURVEYOR'S STATEMENT:

THIS PARCEL MAP WAS PREPARED BY ME OR UNDER MY DIRECTION AND IS BASED UPON A FIELD SURVEY IN CONFORMANCE WITH THE REQUIREMENTS OF THE SUBDIVISION MAP ACT AND LOCAL ORDINANCE AT THE REQUEST OF KATHY KUHNER IN JANUARY OF 2015. I HEREBY STATE THAT THIS PARCEL MAP SUBSTANTIALLY CONFORMS TO THE APPROVED OR CONDITIONALLY APPROVED TENTATIVE PARCEL MAP, IF ANY. I FURTHER STATE THAT THE MONUMENTS ARE OF THE CHARACTER AND OCCUPY THE POSITIONS INDICATED, AND THE MONUMENTS ARE SUFFICIENT TO ENABLE THE SURVEY TO BE RETRACED.

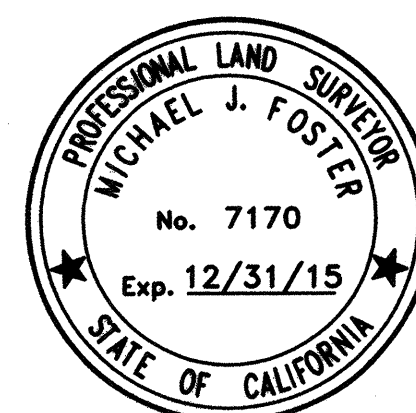

Michael J. Foster
MICHAEL J. FOSTER, L.S. 7170

DATE: JULY 28, 2015

CLERK OF THE BOARD OF SUPERVISORS STATEMENT:

I, ANIKA CAMPBELL-BELTON, CLERK OF THE BOARD OF SUPERVISORS OF THE COUNTY OF ALAMEDA, STATE OF CALIFORNIA, DO HEREBY STATE THAT CERTIFICATES HAVE BEEN FILED AND DEPOSITS HAVE BEEN MADE IN CONFORMANCE WITH THE REQUIREMENTS OF SECTION 66492 AND 66493 OF THE GOVERNMENT CODE OF THE STATE OF CALIFORNIA.

DATED: 8/7/15

ANIKA CAMPBELL-BELTON, CLERK OF THE BOARD OF SUPERVISORS, COUNTY OF ALAMEDA, STATE OF CALIFORNIA

BY: Daniela Jones
DEPUTY CLERK \$20,227.00

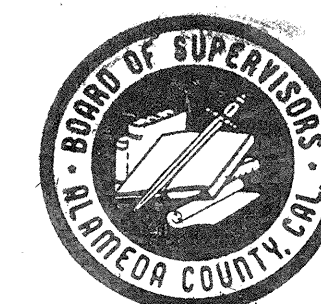

RECORDER'S STATEMENT:

FILED THIS 11th DAY OF August, 2015, AT 1:03 P.M. IN BOOK 320
OF PARCEL MAPS, AT PAGES 22-23, AT THE REQUEST OF CHICAGO TITLE COMPANY.

Fee: \$11.00

Doc: 2015225305

STEVE MANNING
COUNTY RECORDER

BY: Kelly Gunn
DEPUTY COUNTY RECORDER

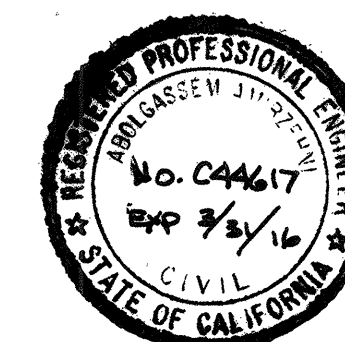

PARCEL MAP NO. 10337 A TWO LOT SUBDIVISION

A PORTION OF LOT 4, BLOCK J, CLAREMONT
CHABOT TRACT, FILED JUNE 23, 1913 (28 M 28)
OAKLAND, ALAMEDA COUNTY, CALIFORNIA
JULY, 2015

BAY AREA LAND SURVEYING INC.

961 MITCHELL WAY
EL SOBRANTE CALIFORNIA 94803
(510) 223-5167