

PROFILE & GRADE MAP
OF
CAMPBELL AVE.
IN TOWN OF
CAMPBELL

Scale: 1" = 40' Hor. & 6' Ver.
April 1912 J. G. McMillan
Co. Surveyor

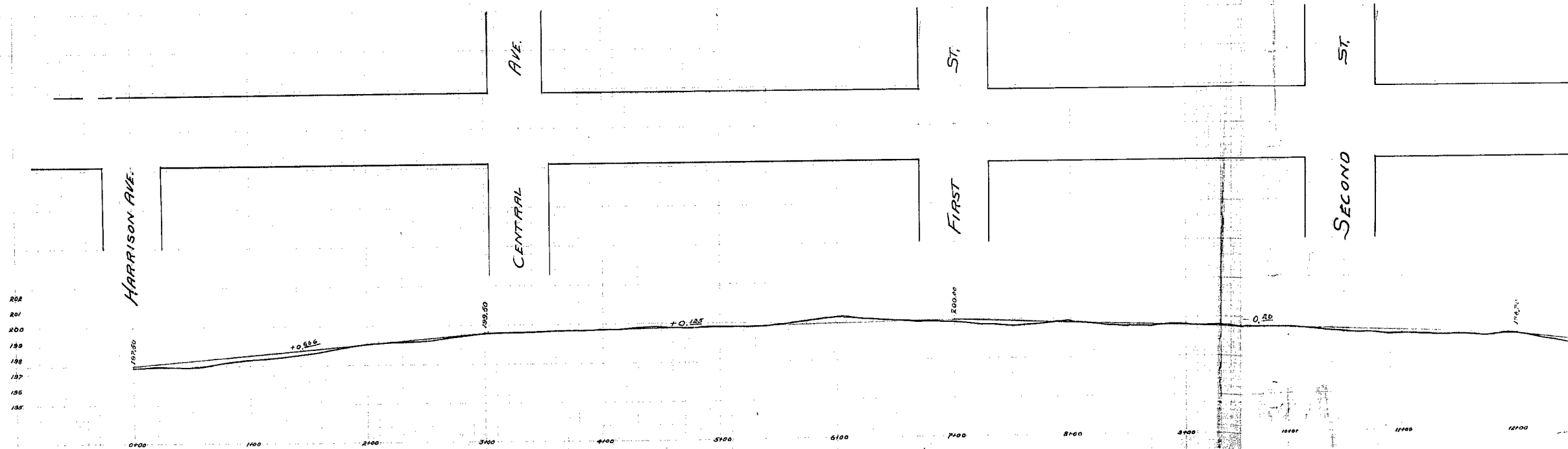

805

908

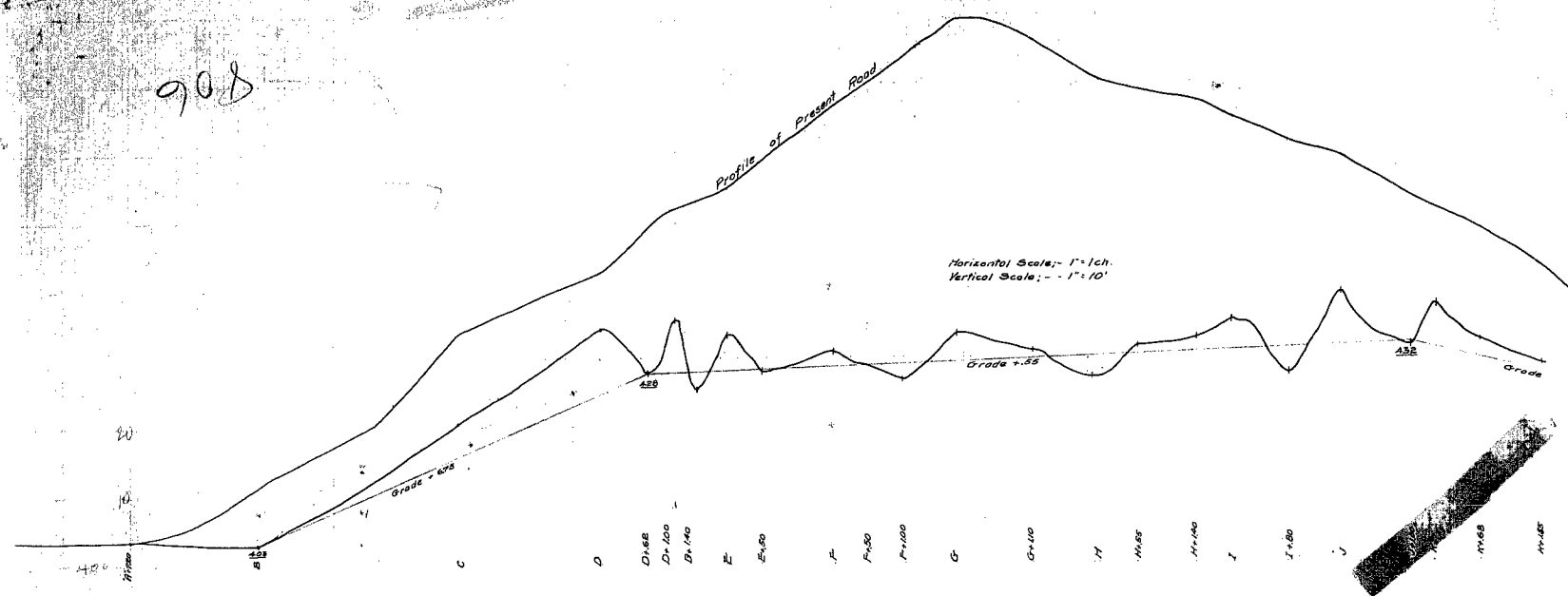

Horizontal Scale:- $1'' = 1 \text{ ch}$
Vertical Scale:- $1'' = 10'$

PLAN AND PROFILE FOR PROPOSED CHANGE IN COCHRAN ROAD

SCALE:- 1" = 1 chain

SURVEYED APR 1911 BY
J.G. McMillan, Co. Surveyor.

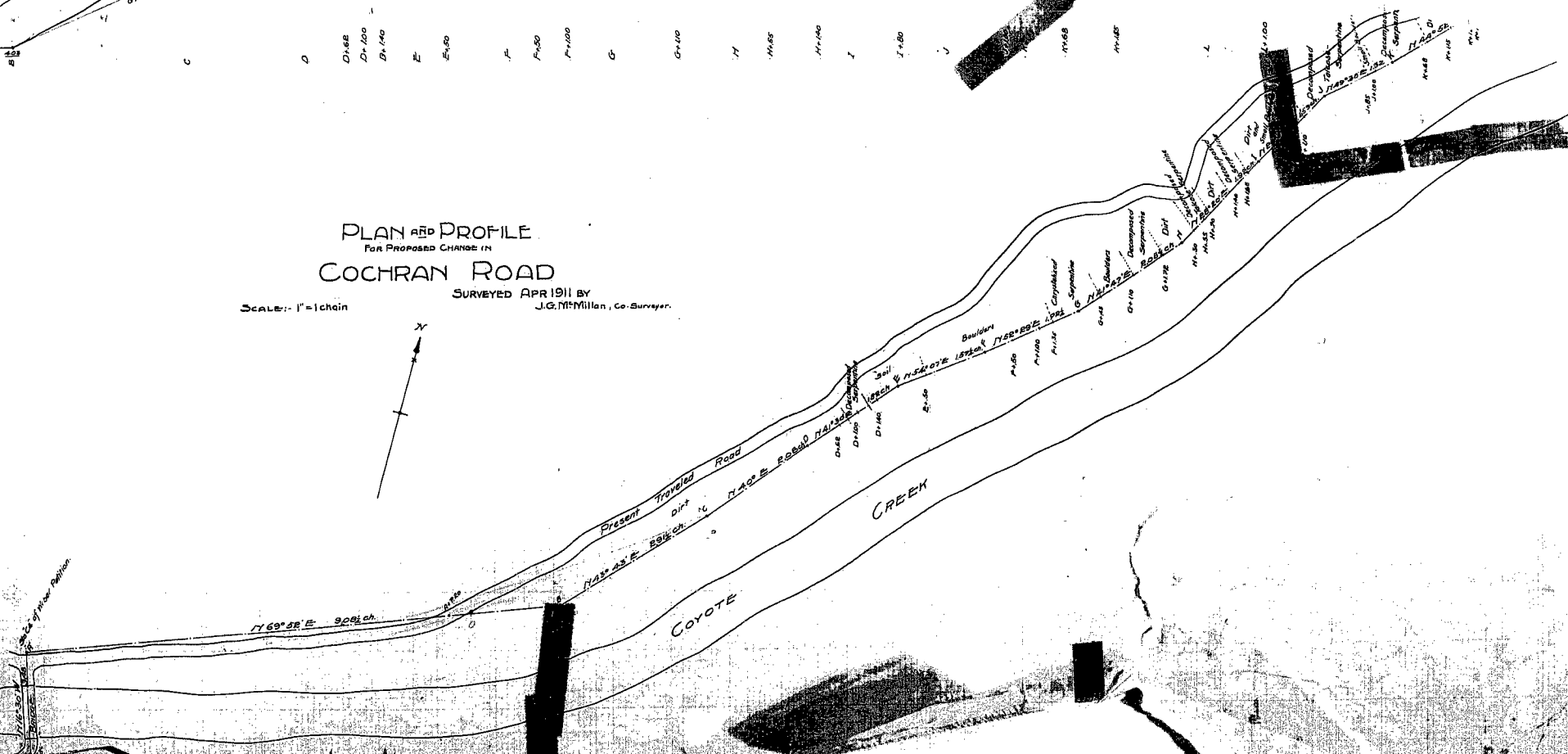

806

MICROFILM
OFFICE OF THE
COMMUNITY SURVEY FOR
CRIMINAL JUSTICE

25

POKEY CITY

430

H + 55 430

430

806

806 806

CROSS-SECTIONING
COCHRAN ROAD

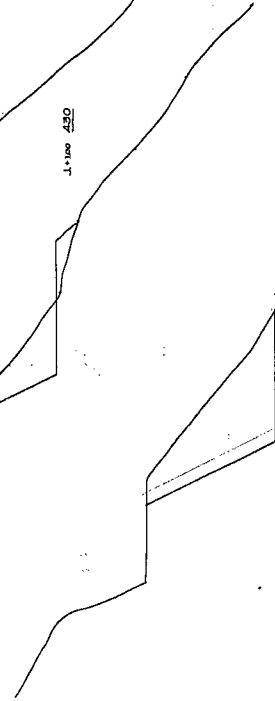
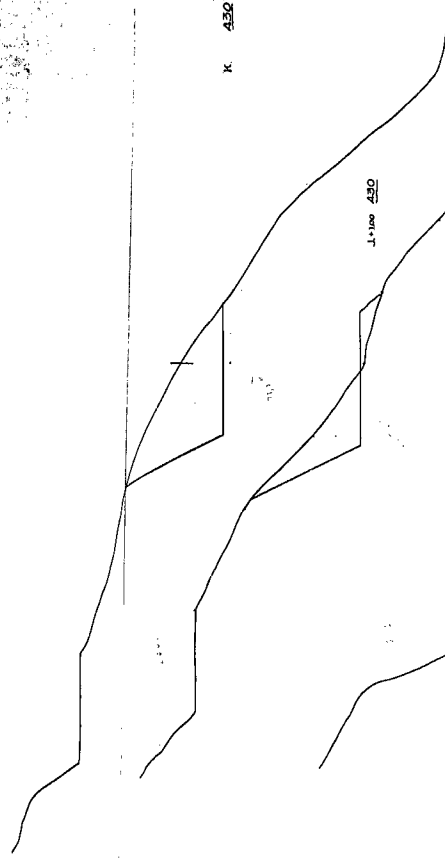
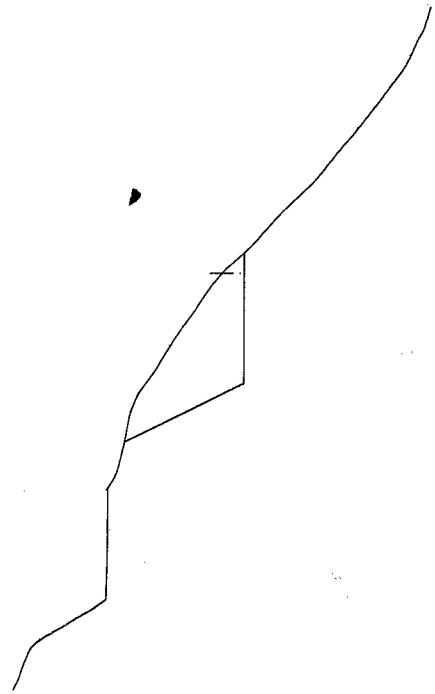
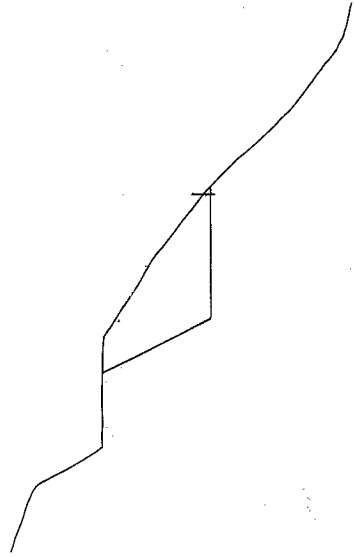
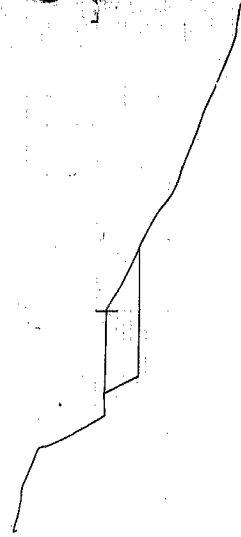

806

D-100 A30

806

806 CS

D-140 430

E 430

E-50 430

F 430

F-50 430

F-100 430

MICROFILM
PROPERTY OF
SANTA CLARA CO.
OFFICE OF THE
COUNTY SURVEYOR
DRAWING NUMBER
806CS

