

Apr. 07, 2020 - 5:22pm. Plotted By: kurt.veeder V:\026800-Panda Express - Master 2018\026800.05-Canal Winchester, OH\04-DWG\Envi Sheet\026800.05-SHOTS-EROSN.dwg Layout: EROSION CONTROL PLAN

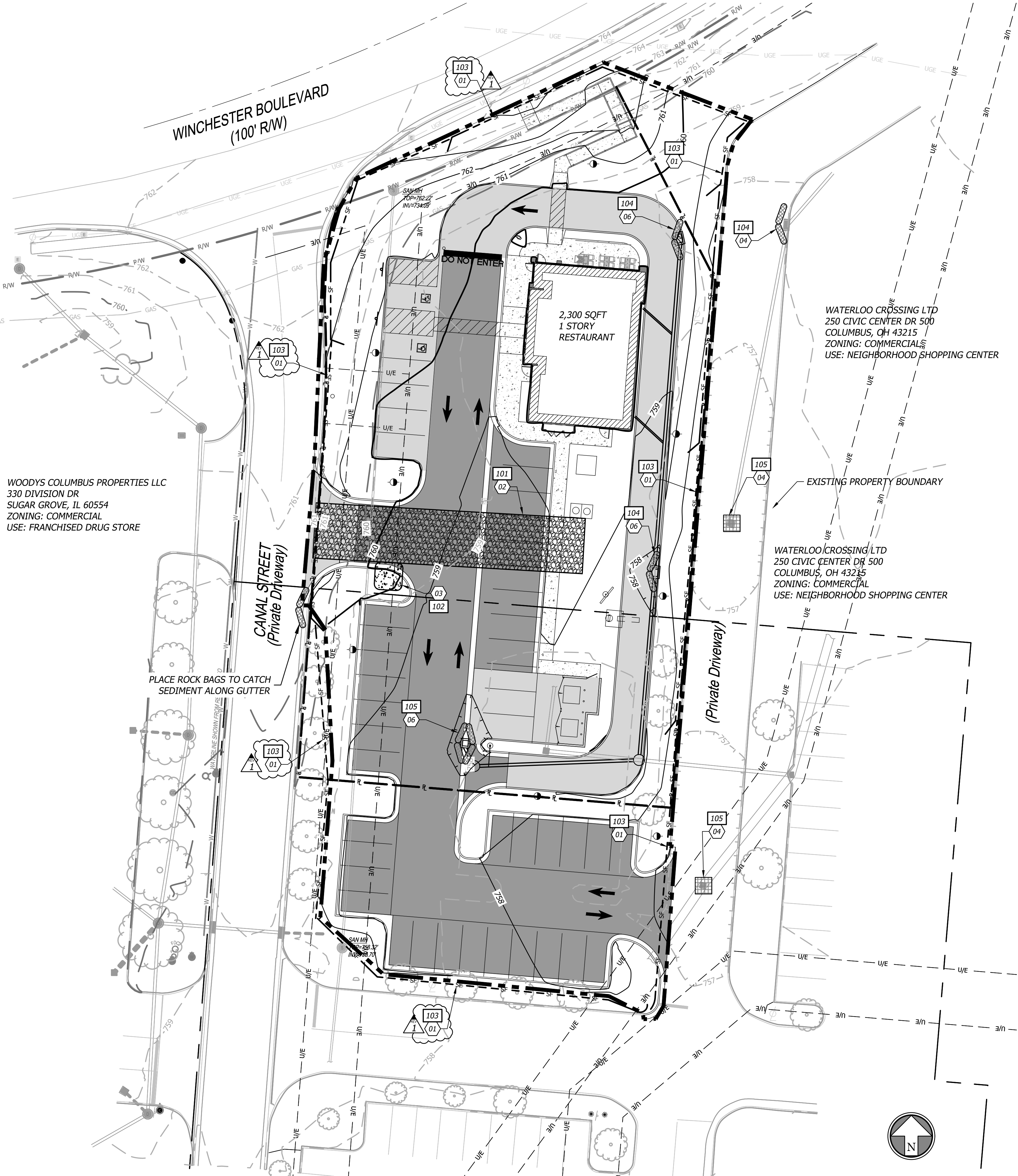

EROSION CONTROL NOTES

1. PRIOR TO LAND DISTURBANCE ACTIVITIES, THE CONTRACTOR SHALL:
  - CONSTRUCT A STABILIZED ENTRANCE/PARKING/DELIVERY AREA.
  - INSTALL PERIMETER CONTROLS AND REQUEST THE INSPECTION OF THE PRE-CONSTRUCTION EROSION AND SEDIMENT CONTROL MEASURES DESIGNATED ON THE APPROVED EROSION AND SEDIMENT CONTROL PLAN. LAND DISTURBANCE WORK SHALL NOT PROCEED UNTIL THERE IS A SATISFACTORY INSPECTION.
  - IDENTIFY THE LIMITS OF CONSTRUCTION ON THE GROUND WITH EASILY RECOGNIZABLE INDICATIONS SUCH AS CONSTRUCTION STAKING, CONSTRUCTION FENCING, AND PLACEMENT OF PHYSICAL BARRIERS OR OTHER MEANS ACCEPTABLE TO THE INSPECTOR AND IN CONFORMANCE WITH THE EROSION AND SEDIMENT CONTROL PLAN.
2. THE CONTRACTOR SHALL COMPLY WITH ALL REQUIREMENTS OF THE FEDERAL CLEAN WATER ACT, OHIO EPA, AND NPDES STORMWATER RUNOFF FROM CONSTRUCTION SITES GENERAL PERMIT, INCLUDING BUT NOT LIMITED TO:
  - THE CONTRACTOR SHALL SEED, MULCH, OR OTHERWISE STABILIZE ANY DISTURBED AREA WHERE THE LAND DISTURBANCE ACTIVITY HAS CEASED FOR MORE THAN 14 DAYS.
  - THE CONTRACTOR SHALL PERFORM INSPECTIONS OF EROSION AND SEDIMENT CONTROL MEASURES AT THE FOLLOWING MINIMUM INTERVALS:
    - DURING ACTIVE CONSTRUCTION PHASES - AT LEAST ONCE PER WEEK
    - DURING PERIODS OF INACTIVITY - AT LEAST ONCE PER MONTH
    - AFTER EACH RAINFALL EVENT OF ½ INCH OR MORE - WITHIN 24 HOURS OF THE RAIN EVENT
  - THE CONTRACTOR SHALL MAINTAIN AN INSPECTION LOG INCLUDING THE INSPECTOR'S NAME, DATE OF INSPECTION, OBSERVATIONS AS TO THE EFFECTIVENESS OF THE EROSION AND SEDIMENT CONTROL MEASURES, ACTIONS NECESSARY TO CORRECT DEFICIENCIES, WHEN THE DEFICIENCIES WERE CORRECTED, AND THE SIGNATURE OF THE PERSON PERFORMING THE INSPECTION. THE INSPECTION LOG SHALL BE AVAILABLE FOR REVIEW BY THE REGULATORY AUTHORITY.
  - THE CONTRACTOR SHALL HAVE THE EROSION AND SEDIMENT CONTROL PLAN ROUTINELY UPDATED TO SHOW ALL CHANGES AND AMENDMENTS TO THE PLAN. A COPY OF THE EROSION AND SEDIMENT CONTROL PLAN SHALL BE KEPT ON SITE AND MADE AVAILABLE FOR REVIEW BY THE REGULATORY AUTHORITY.
3. PERMANENT SEEDING SHALL BE INSTALLED AFTER COMPLETION OF FINAL GRADING EXCEPT WHEN SEEDING WILL OCCUR OUTSIDE OF THE ACCEPTABLE SEEDING SEASON. WHEN TEMPORARY SEEDING IS INSTALLED, PERMANENT SEEDING SHALL BE INSTALLED AT THE NEXT SEEDING SEASON. TEMPORARY SEEDING SHALL NOT BE USED AS A STABILIZATION MEASURE FOR A PERIOD EXCEEDING 12 MONTHS. THE PERMIT WILL NOT BE CLOSED UNTIL PERMANENT SEEDING HAS BEEN ESTABLISHED TO A MINIMUM OF 70% DENSITY OVER THE ENTIRE DISTURBED AREA.
4. THE CONTRACTOR SHALL MAINTAIN INSTALLED EROSION AND SEDIMENT CONTROL DEVICES IN A MANNER THAT PRESERVES THEIR EFFECTIVENESS FOR PREVENTING SEDIMENT FROM LEAVING THE SITE OR ENTERING A SENSITIVE AREA SUCH AS A NATURAL STREAM CORRIDOR, AREAS OF THE SITE INTENDED TO BE LEFT UNDISTURBED, A STORM SEWER, OR AN ON-SITE DRAINAGE CHANNEL.
5. THE CONTRACTOR IS RESPONSIBLE FOR PROVIDING EROSION AND SEDIMENT CONTROL FOR THE DURATION OF A PROJECT. IF THE CITY DETERMINES THAT THE BMPs IN PLACE DO NOT PROVIDE ADEQUATE EROSION AND SEDIMENT CONTROL AT ANY TIME DURING THE PROJECT, THE CONTRACTOR SHALL INSTALL ADDITIONAL OR ALTERNATE MEASURES THAT PROVIDE EFFECTIVE CONTROL.
6. CONCRETE WASH OR RINSE WATER FROM CONCRETE MIXING EQUIPMENT, TOOLS AND/OR CONCRETE TRUCKS, TOOLS, ETC. MAY NOT BE DISCHARGED INTO OR BE ALLOWED TO RUN DIRECTLY INTO ANY EXISTING WATER BODY OR STORM INLET. ONE OR MORE LOCATIONS FOR CONCRETE WASH OUT WILL BE DESIGNATED ON SITE, SUCH THAT DISCHARGES DURING CONCRETE WASHOUT WILL BE CONTAINED IN A SMALL AREA WHERE WASTE CONCRETE CAN SOLIDIFY IN PLACE.
7. CHEMICALS OR MATERIALS CAPABLE OF CAUSING POLLUTION MAY ONLY BE STORED ONSITE IN THEIR ORIGINAL CONTAINER. MATERIALS STORED OUTSIDE MUST BE IN CLOSED AND SEALED WATER-PROOF CONTAINERS AND LOCATED OUTSIDE OF DRAINAGE WAYS OR AREAS SUBJECT TO FLOODING. LOCKS AND OTHER MEANS TO PREVENT OR REDUCE VANDALISM SHALL BE USED. SPILLS WILL BE REPORTED AS REQUIRED BY LAW AND IMMEDIATE ACTIONS TAKEN TO CONTAIN THEM.
8. SILT FENCES AND EROSION CONTROL BMPs WHICH ARE SHOWN ALONG THE BACK OF CURB MUST BE INSTALLED WITHIN TWO WEEKS OF CURB BACKFILL AND PRIOR TO PLACEMENT OF BASE ASPHALT. EXACT LOCATIONS OF THESE EROSION CONTROL METHODS MAY BE FIELD ADJUSTED TO MINIMIZE CONFLICTS WITH UTILITY CONSTRUCTION; HOWEVER, ANTICIPATED DISTURBANCE BY UTILITY CONSTRUCTION SHALL NOT DELAY INSTALLATION.
9. SEE LANDSCAPE PLAN AND DETAIL FOR FINAL SURFACING SPECIFICATIONS.

EROSION/SEDIMENT CONTROL STAGING CHART				
Project Stage	BMP Plan Ref No.	BMP Description	Remove after stage:	Notes:
A - Place BMP's Prior to Land Disturbance.	01	Perimeter Silt Fence	D	Place as shown on plan.
	02	Construction Entrance & Staging Area	D	Place as shown on plan.
	03	Concrete Wash-out	D	Place as shown on plan.
	04	Storm Inlet Protection	D	Place as shown on plan.
B - After stripping, grubbing, & mass grading	05	Interior Silt Fence	D	To be placed and removed per construction schedule - general location shown on plan.
C - After Utility Storm Sewer Construction	06	Storm Inlet Protection	D	Place as shown on plan.
D - Final Grading, Paving & Landscaping		Final Seeding, Sod and Landscaping	N/A	Silt fencing & inlet protection may be removed once seed & sodded areas are established on 70% of site.

DETAILS

- SEE CIVIL DETAIL SHEET C8.3

- 101 TEMPORARY CONSTRUCTION ENTRANCE
- 102 CONCRETE WASH-OUT
- 103 FILTER FABRIC SILT FENCE
- 104 DANDY CURB SACK
- 105 DANDY SACK AREA INLET FILTER

LEGEND

- 980 FINISH GRADE 5' CONTOURS
- 979 FINISH GRADE 1' CONTOURS
- 980 EXISTING GRADE 5' CONTOURS
- 979 EXISTING GRADE 1' CONTOURS
- R/W RIGHT-OF-WAY LINE
- PROPERTY LINE
- ADJACENT PROPERTY LINE
- PROPOSED STORM SEWER MAIN
- SF SILT FENCE
- DISTURBED AREA (0.97 ACRES)
- ROCK BAGS
- AREA INLET FILTER
- CONSTRUCTION ENTRANCE
- CONCRETE WASH OUT
- FINISHED SURFACE - CONCRETE PAVEMENT
- FINISHED SURFACE - CONCRETE SIDEWALK
- FINISHED SURFACE - ASPHALT PARKING

**BHC RHODES**  
Civil Engineering • Surveying • Utilities  
7101 College Blvd., Suite 400  
Overland Park, Kansas 66210  
p. (913) 663-1900 f. (913) 663-1633  
BHC RHODES is a trademark of Brungardt Honnrich & Company, P.A.



PANDA EXPRESS, INC.  
1683 Walnut Grove Ave.  
Rosemead, California  
91770  
Telephone: 626.799.9898  
Facsimile: 626.372.8288

All ideas, designs, arrangement and plans indicated or represented by this drawing are the property of Panda Express Inc. and were created for use on this specific project. None of these ideas, designs, arrangements or plans may be used by or disclosed to any person, firm, or corporation without the written permission of Panda Express Inc.

REVISIONS:

- TECHNICAL REVIEW GROUP 03.17.20
- TECHNICAL REVIEW GROUP 04.07.20

ISSUE DATE:

- 1st PERMIT/BID SET 01-13-20

DRAWN BY: KMY

PANDA PROJECT #: S8-20-D6790  
ARCH PROJECT #: 18044.035



**hckloverarchitect**  
8813 Penrose Lane, Suite 400,  
Lenexa, KS 66219  
ph: 913.649.8181 • fx: 913.649.1275

PANDA EXPRESS

TRUE WARM & WELCOME 2300 R1  
CANAL ST. & WINCHESTER BLVD  
CANAL-WINCHESTER, OH 43110

EROSION CONTROL PLAN

C7.0

TRUE WARM & WELCOME 2300 R1

PERMIT/BID SET 01-13-20