

# CORNER RECORD

Agency Index

BK 111 PG 20

Document Number

CR 11517

City of OAKLANDCounty of ALAMEDA, CaliforniaBrief Legal Description WELL MONUMENT LOCATED WITHIN MARKET ST  
AT THE INTERSECTION OF 24TH ST

CITY OF OAKLAND MON ID:

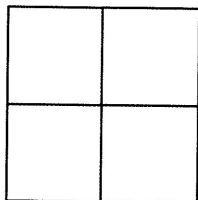

## CORNER TYPE

## COORDINATES (Optional)

Government Corner	<input type="checkbox"/>	Control	<input checked="" type="checkbox"/>
Meander	<input type="checkbox"/>	Property	<input type="checkbox"/>
Rancho	<input type="checkbox"/>	Other	<input type="checkbox"/>

N. \_\_\_\_\_ E. \_\_\_\_\_

Elevation \_\_\_\_\_

Units Metric ☐ U.S. Survey Foot ☐

Horizontal Datum \_\_\_\_\_

Zone \_\_\_\_\_ Epoch Date \_\_\_\_\_

Vertical Datum \_\_\_\_\_

☐ Complies with Public Resources Code §§8801-8819☐ Complies with Public Resources Code §§8890-8902Date of Survey 5/15/18PLS Act Ref: ☐ 8765(d) ☒ 8771 ☐ 8773 ☐ Other:

Corner/ Monument:	<input checked="" type="checkbox"/> Left as found	<input type="checkbox"/> Established	<input type="checkbox"/> Rebuilt	<input checked="" type="checkbox"/> Pre-Construction
	<input type="checkbox"/> Found and tagged	<input type="checkbox"/> Reestablished	<input checked="" type="checkbox"/> Referenced	<input type="checkbox"/> Post-Construction

Narrative of corner identified and monument as found, set, reset, replaced, or removed:

☐ See sheet #2 for description(s) :

FOUND 0.25" PIN IN CONCRETE IN MONUMENT WELL.

MONUMENT PAVED OVER. EXCAVATED PRIOR TO REFERENCING. FOUND 3" BELOW GRADE.

FOUND AND SET POINTS AS SHOWN ON PAGE 2.

THIS POINT WAS REFERENCED PRIOR TO A CONSTRUCTION PROJECT IN THE VICINITY.

THE TIES SHOWN HEREON ARE FOR THE PURPOSE OF PERPETUATING FOUND MONUMENTATION.

NO CLAIM IS MADE AS TO THE RELATIONSHIP OF THE POINTS OR LINES SHOWN HEREON TO TRUE BOUNDARY LOCATION.

## SURVEYOR'S STATEMENT

This Corner Record was prepared by me or under my direction in conformance with

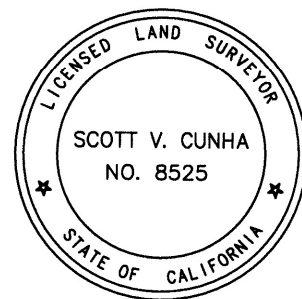
the Professional Land Surveyors' Act on JUNE 4, 2018.Signed SCOTT V. CUNHA P.L.S. or R.C.E. No. LS 8525

## COUNTY SURVEYOR'S STATEMENT

This Corner Record was received 5 JUNE 2018and examined and filed 2 AUGUST 2018Signed Michael Rubner P.L.S. or R.C.E. No. 6843Title COUNTY SURVEYOR

County Surveyor's Comment

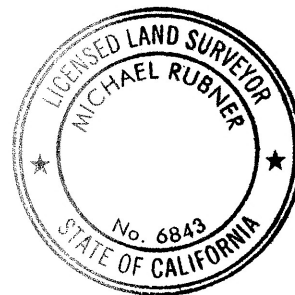

SCALE: 1"=30'

# LEGEND

- FOUND 0.25" PIN IN CONCRETE IN MONUMENT WELL
- SET REBAR & CAP
- ⊗ SET CUT CROSS IN WALK
- ⊗ SET MAG AND SHINER "CUNHA RP"
- ⊗ SET CUT CROSS IN CURB
- AA##A# ALAMEDA COUNTY MONUMENT ID
- 19592 REFERENCE STREET ADDRESS

